

OYSTER PIER

2011

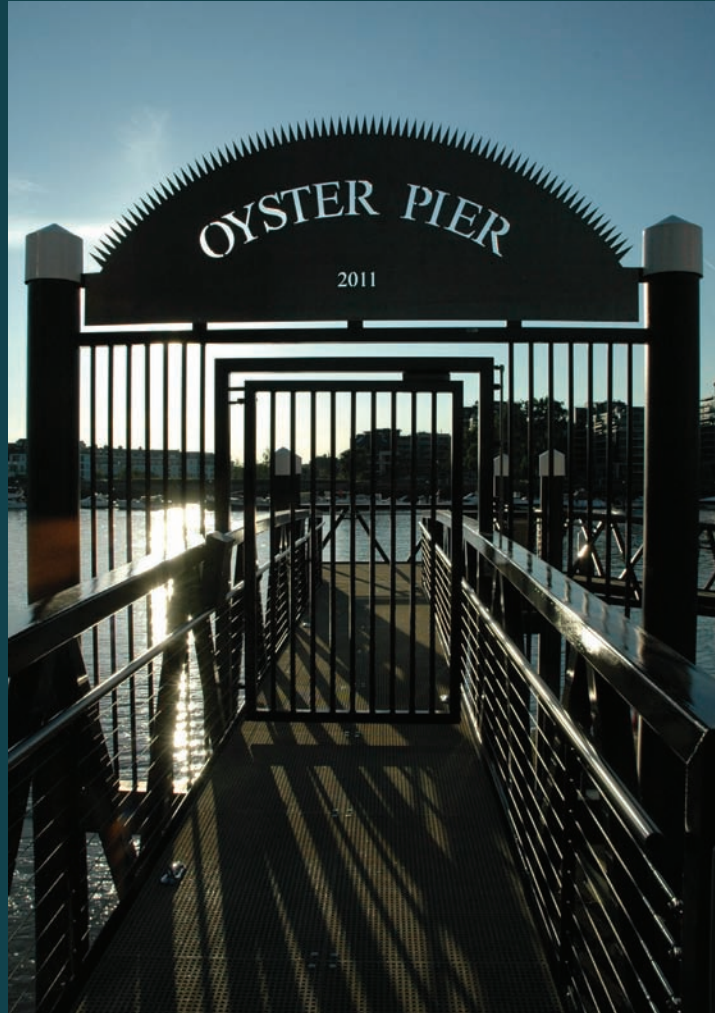



This bespoke barge was sourced in Northern Europe and refurbished to a high standard in the UK. Offering up to 2,300 sq ft of living space and up to 730 sq ft of outdoor usable space. This barge has a unique 60 year lease at Oyster Pier and is independently navigable.

- The Oyster Pier Advantage**
- Residents of Oyster Pier will benefit from an extensive menu of hotel concierge services.
 - Discounts from 5* Hotel Rafayel, including housekeeping services and room service.
 - Highly secure entrance to the pier with a resident Piermaster and CCTV cameras on the pier.
 - Secure underground parking and residential on-street parking available.
 - Ease of access out of the city from the water or heliport.
 - Prices for barge (and mooring) with basic fit-out will start at £1.5 million.
 - Barges will take 6 - 8 months from order to completion.



Barge Floor Plan

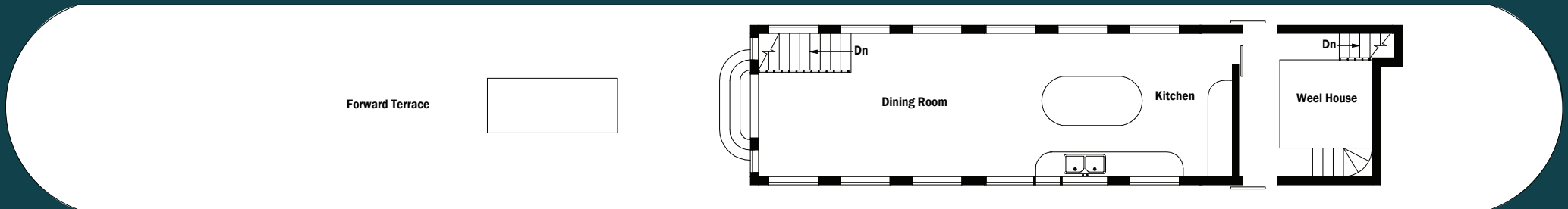

First Floor

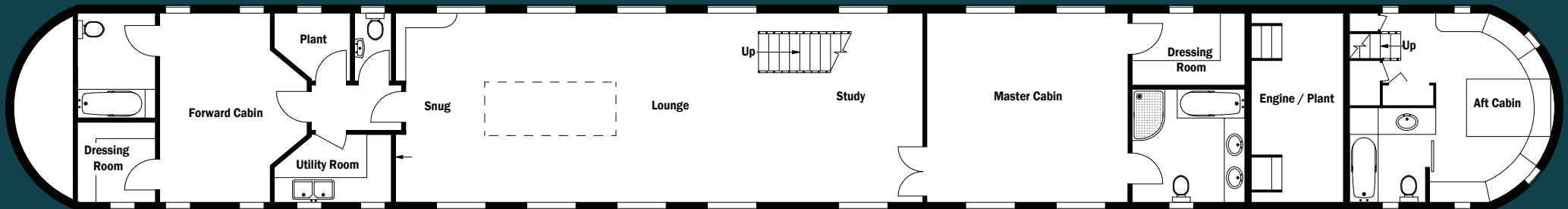

Ground Floor

020 7589 6677

1 Cadogan Street London SW3 2PP
www.bectivelesliemarsh.co.uk
chelsea@bectivelesliemarsh.co.uk

Misrepresentation Act 1967. This brochure and the descriptions and measurements herein do not constitute representation and whilst every effort has been made to ensure accuracy, this cannot be guaranteed.

**BECTIVE
 LESLIE
 MARSH**